

# M.543 Bridge handles

Technopolymer

INCH



## MATERIAL

Glass-fibre reinforced polyamide based (PA) technopolymer, black colour, matte finish.

## STANDARD EXECUTION

Brass bosses, threaded blind holes.

## TECHNICAL DATA

Tensile stress and impact strength: F1, F2, L1 and L2 values reported in the table are the result of breaking tests carried out with the appropriate dynamometric equipment under the test conditions shown in the figure with ambient temperature.

## OTHER EXECUTIONS ON REQUEST

Orange RAL 2004 colour.

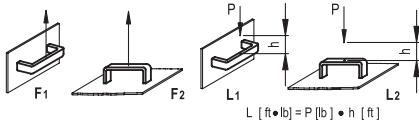

ELESA Original design

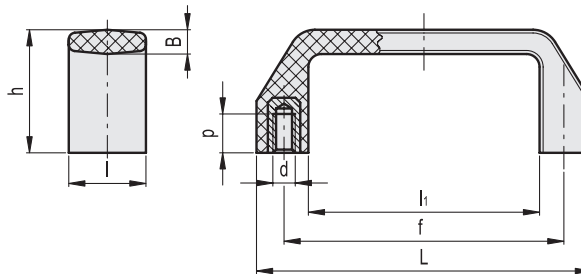

INCH

Code	Description	L	f	d2B	h	B	l	li	p	F1 [lbf]	F2 [lbf]	L1 [ft-lb]	L2 [ft-lb]	⚖
937283	M.543/110 B-1/4-20	4.21	3.68±0.02	1/4-20	1.42	0.24	0.83	3.11	0.39	448	403	7	4	0.08
937285	M.543/120 B-1/4-20	4.72	4.13±0.02	1/4-20	1.46	0.28	0.91	3.54	0.39	448	403	7	5	0.08
937287	M.543/140 B-1/4-20	5.28	4.61±0.02	1/4-20	1.5	0.3	0.98	4.02	0.47	672	358	9	7	0.12
937291	M.543/140 B-5/16-18	5.28	4.61±0.02	5/16-18	1.5	0.3	0.98	4.02	0.51	672	358	9	7	0.11
937296	M.543/150 B-5/16-18	5.91	5.2±0.02	5/16-18	1.77	0.3	1.02	4.57	0.51	448	403	13	12	0.13

- 1
- 2
- 3
- 4
- 5
- 6
- 7
- 8
- 9
- 10
- 11
- 12
- 13
- 14
- 15
- RH

Lift and pull handles